



*Alen Wu*

*Contact number /Whatsapp: +86 138 2231 8272*

*E-mail: alen@cgreenhouse.com*



(Wechat)



(Whatsapp)

CGC MOVING HOUSE TECHNOLOGY CO.,LTD.



 [www.cgcontainer.com](http://www.cgcontainer.com)

CGC MOVING HOUSE TECHNOLOGY CO.,LTD.

[www.cgcontainer.com](http://www.cgcontainer.com)

MODULAR HOUSING



# CONTENTS

1

ABOUT US

PREFABRICATED HOUSE

2

3

STEEL STRUCTURE FEATURES





# COMPANY PROFILE

CGC Moving House Technology Co., Ltd.(hereinafter referred to as 'CGC') is positioned on Shipping flat pack container, modular buildings and steel structure buildings, focusing on manufacturing, selling, leasing and general engineering contracting Shipping Flat-Pack Containers are self-developed and fabricated products by CGC, which reaches an annual output of more than 60,000 units, while steel structure reaches more than 30,000 tons. Guangdong Zhonghui Green Construction Co., Ltd—— 100% holding subsidiary by CGC, owns seven qualifications which are general contracting for construction projects, facade engineering contracting, steel structure engineering contracting, mechanical and electrical engineering construction general contracting, building decoration contracting, general contracting of municipal public works construction and contracting of environmental protection projects.

CGC promotes our products and services to the world, and we own a first-level branch-Singapore C-BOX PRIVATE LIMITED; At the same time, the second subsidiaries are established in Indonesia, Myanmar, Thailand and Cambodia, where contain display base over 50,000 square me

CGC strives to keep up with China's reforms through innovation of product, management, institution and business model. We also follow closely along with the pace of Reform and Open system of China, and wish to grow rapidly into a transnational & international enterprise.





中辉绿建  
CHINA GREEN CONTAINER



# STRATEGIC PARTNERS



# QUALIFICATION CERTIFICATION



# COMPANY

# CULTURE

## CGC Culture

### ● Our Mission

Create a safe, happy and beautiful mobile living space for all mankind

### ● Our Vision

Become the world's leading mobile home provider  
Become the most trusted partner of investors  
Become the company most followed by employees in the industry

### ● Our Core Value

Quality Integrity Innovation Win-win

**Quality:** Pay attention to details, strictly control the process, pursue the ultimate, and strive for perfection;

**Integrity:** abide by the contract, guarantee the delivery date, perform due diligence, and be brave to take responsibility;

**Innovation:** Innovation and change, continuous improvement, continuous optimization, pursuit of excellence;

**Win-win:** Peer-to-peer cooperation, frank and mutual communication, harmony to make money, double income and win-win

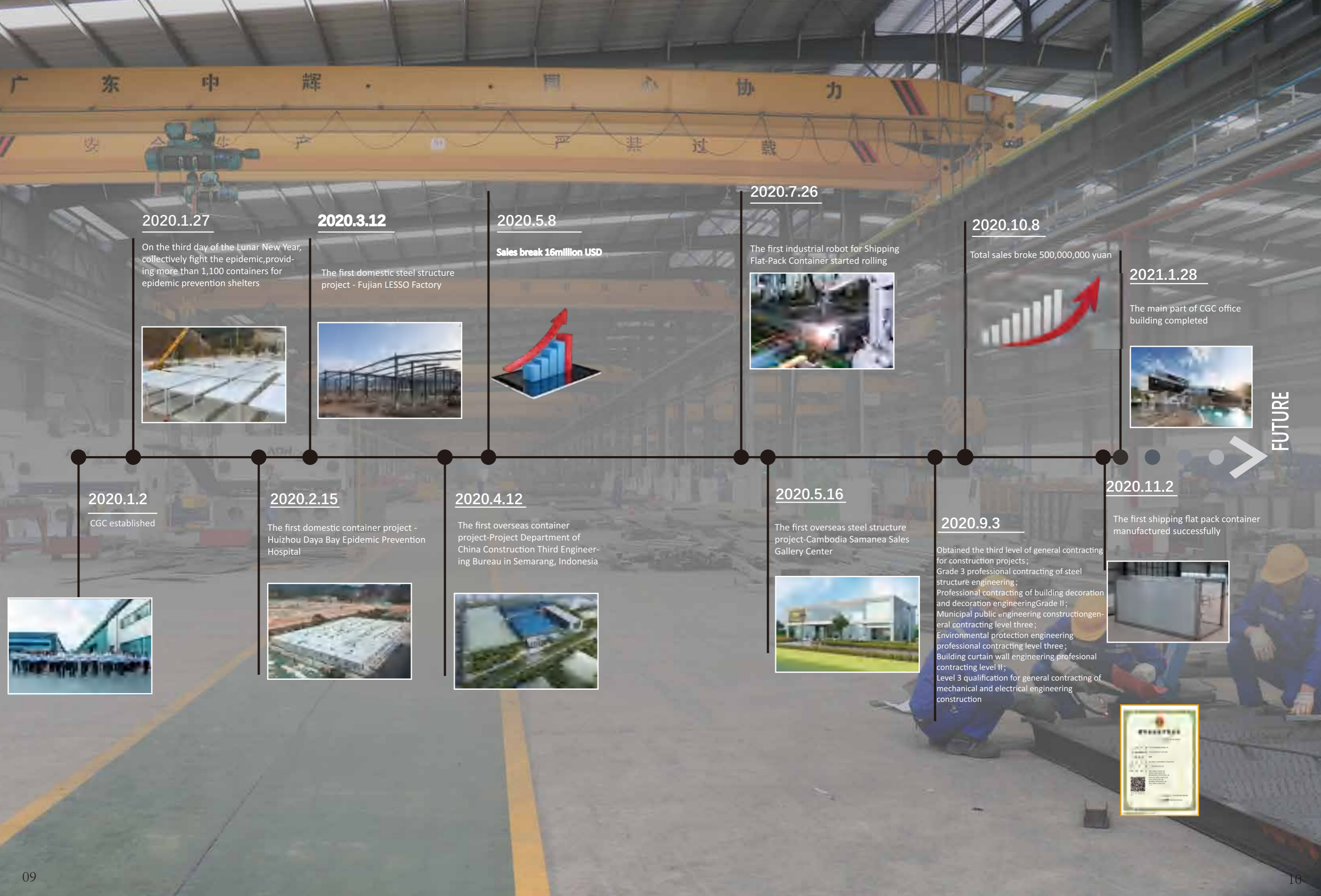

广东中辉

**2020.1.27**

On the third day of the Lunar New Year, collectively fight the epidemic, providing more than 1,100 containers for epidemic prevention shelters



**2020.3.12**

The first domestic steel structure project - Fujian LESSO Factory



**2020.5.8**

**Sales break 16million USD**



**2020.7.26**

The first industrial robot for Shipping Flat-Pack Container started rolling



**2020.10.8**

Total sales broke 500,000,000 yuan

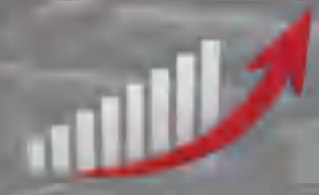

**2021.1.28**

The main part of CGC office building completed



FUTURE



**2020.1.2**

CGC established



**2020.2.15**

The first domestic container project - Huizhou Daya Bay Epidemic Prevention Hospital



**2020.4.12**

The first overseas container project-Project Department of China Construction Third Engineering Bureau in Semarang, Indonesia

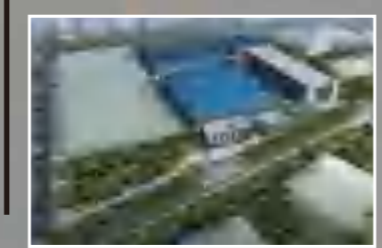

**2020.5.16**

The first overseas steel structure project-Cambodia Samanea Sales Gallery Center



**2020.9.3**

Obtained the third level of general contracting for construction projects;  
Grade 3 professional contracting of steel structure engineering;  
Professional contracting of building decoration and decoration engineering Grade II;  
Municipal public engineering construction general contracting level three;  
Environmental protection engineering professional contracting level three;  
Building curtain wall engineering professional contracting level II;  
Level 3 qualification for general contracting of mechanical and electrical engineering construction

**2020.11.2**

The first shipping flat pack container manufactured successfully



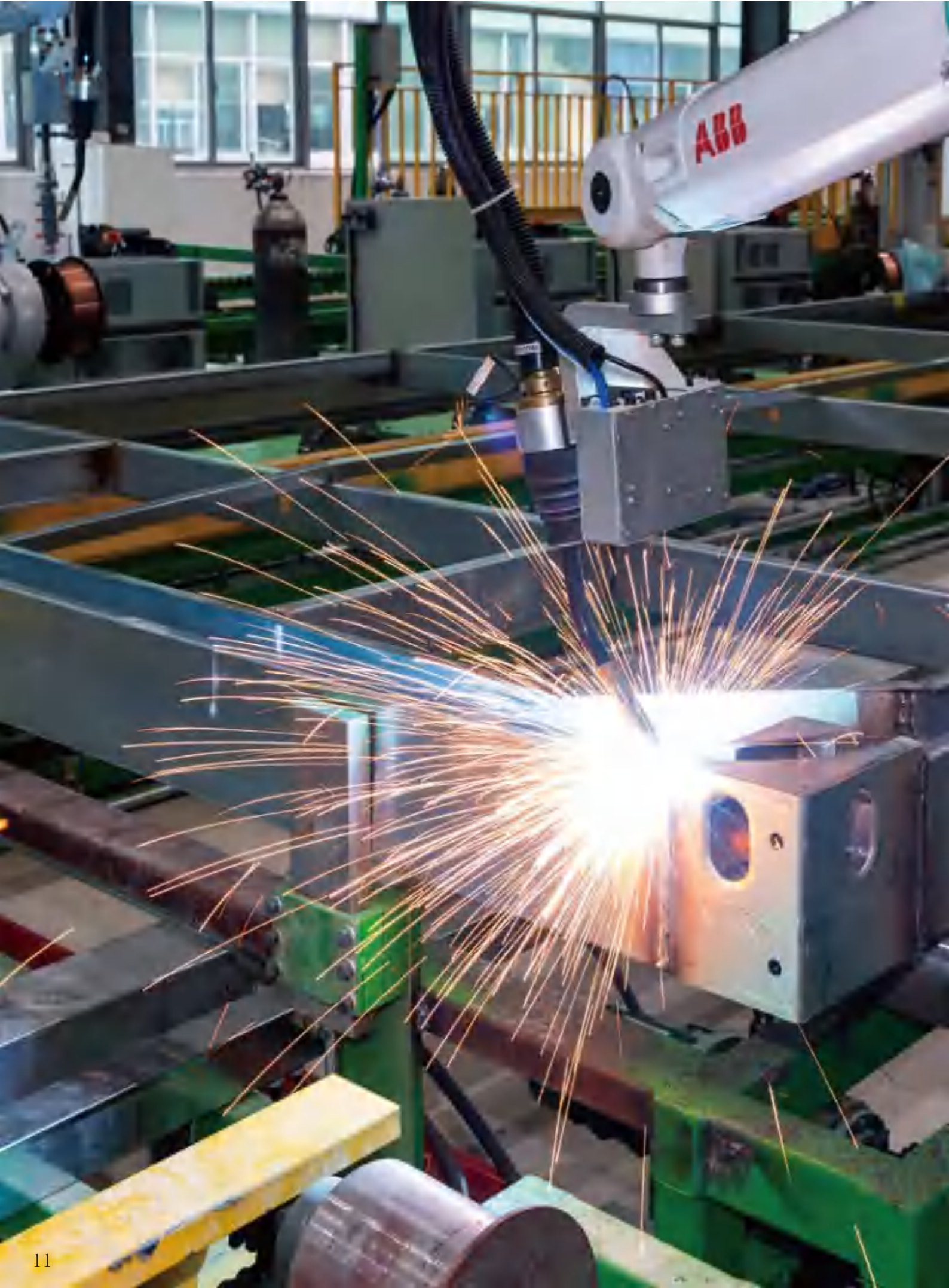

MACHINERY

EQUIPMENT



## Well-equipped and advanced steel structure production line

---

CGC's steel structure production line equipment total investment of more than 3 million USD, production line configuration are currently professional and most advanced manufacturing equipment, it includes CNC flame cutting machine, 2000 type stand-up machine, 30MM plate cutting machine, single/double-wire Gantry submerged arc welding machine, 60B/40A correcting machine, 50MM CNC plane drill, 25MM CNC punching machine, 14 shot blasting machine, rocker drill, etc. .

The entire production line is arranged in the order of the production process, and the intermediate handling is all realized by mechanized operation of driving. At the same time, our visit channel adopts high-quality water-based paint technology. The entire production line fully meets the requirements of smoothness, efficiency and environmental protection. The simultaneous production of the two manufacturing lines can guarantee a monthly production capacity of 3,000 tons of light steel and a production capacity of 30,000 tons of young steel.



## The industry's first-class Shipping Flat Container production line

---

As a leading domestic mobile home provider, CGC, one of its main products-shipping flat pack container, it is manufactured using the industry's only fully automated production line, with a total investment of about 11 million USD in production line equipment. It is currently the most advanced fully automatic seamlessly connected production line in the industry, achieving fully automated, seamless and intelligent production of hoisting, turning, and handling procedures. Its daily output can reach 150-200 units/day. The whole production line is equipped with two sets of professional test equipment, which can be used for water tightness test, penetration test, roof load test, stacking test and side push test. The production line has successfully realized production automation, productivity efficiency, quality assurance, to provide customers with high-end mobile living space of the overall solution.





# PREFABRICATED HOUSE



# SHIPPING FLAT PACK CONTAINER



## Data

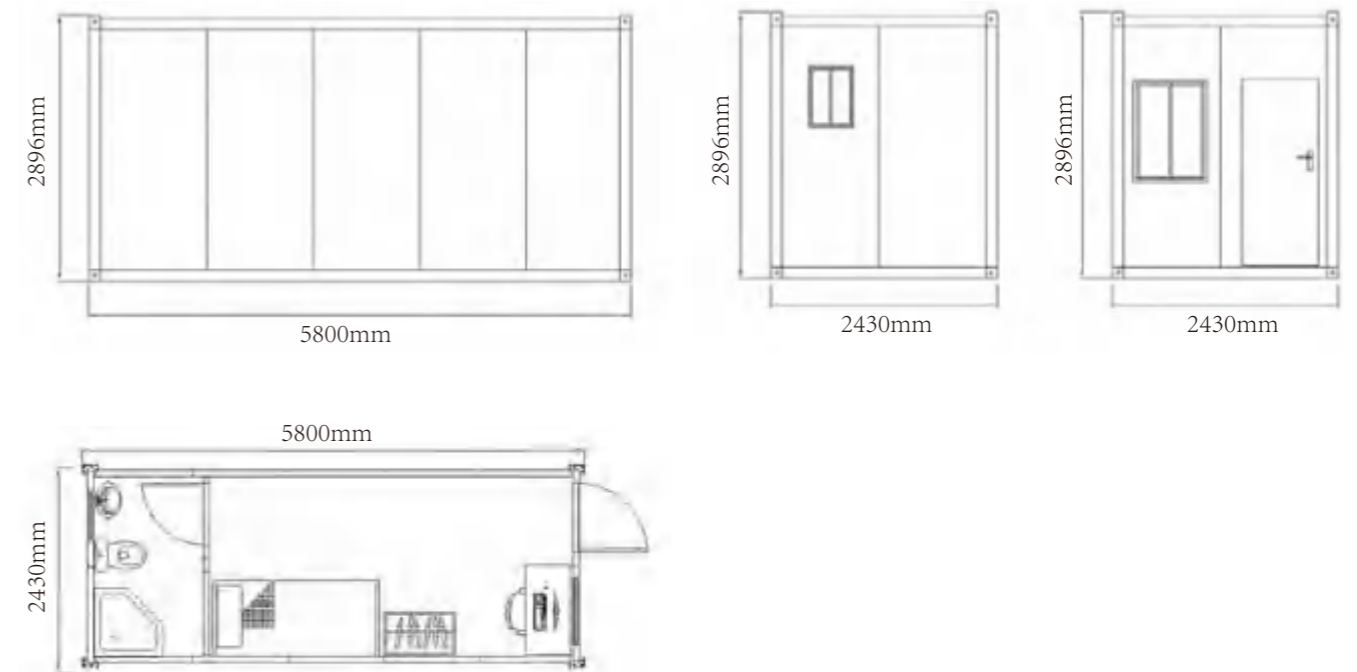

1. The thickness of the top of the Shipping Flat-pack container reaches 1.5mm (only 0.4-0.5mm for similar products); Test of 54 people standing on the top at the same time, no deformation and water leakage;
2. Fully and Automatically welded by robots, no glued, and doubled the service life ;
3. Adopts 360° suspended full spray, anti-corrosion, and maintenance-free within 15 years;
4. With safe and reliable structure, with earthquake resistance level 8 and wind resistance level 12, the overall load-bearing capacity of the roof can reach 2.3 tons, usage period more than 20 years;
5. Diversified combination: taking a single cabinet as a unit, it can be combined arbitrarily. Can be assembled in any length and width direction, can be stacked in three layers, and can be added with decorative roofs and terraces;
6. Energy saving and environmental protection: adopting the 'factory manufacturing + on site installation' model, the project can reduce construction water consumption, concrete damage by about 60%, reduce construction waste and decoration waste by about 70%, save about 50%, and increase overall production efficiency by about 2-3 times;
7. Convenient to move: the overall performance of the packing box is good, and it is convenient to move, without disassembly when moving;
8. It has a wide range of applications and can follow up with different needs. It can be used as office, accommodation, hall, bathroom, kitchen, dining room, recreation room, meeting room, clinic, laundry room, storage room, command post etc



## Product Details

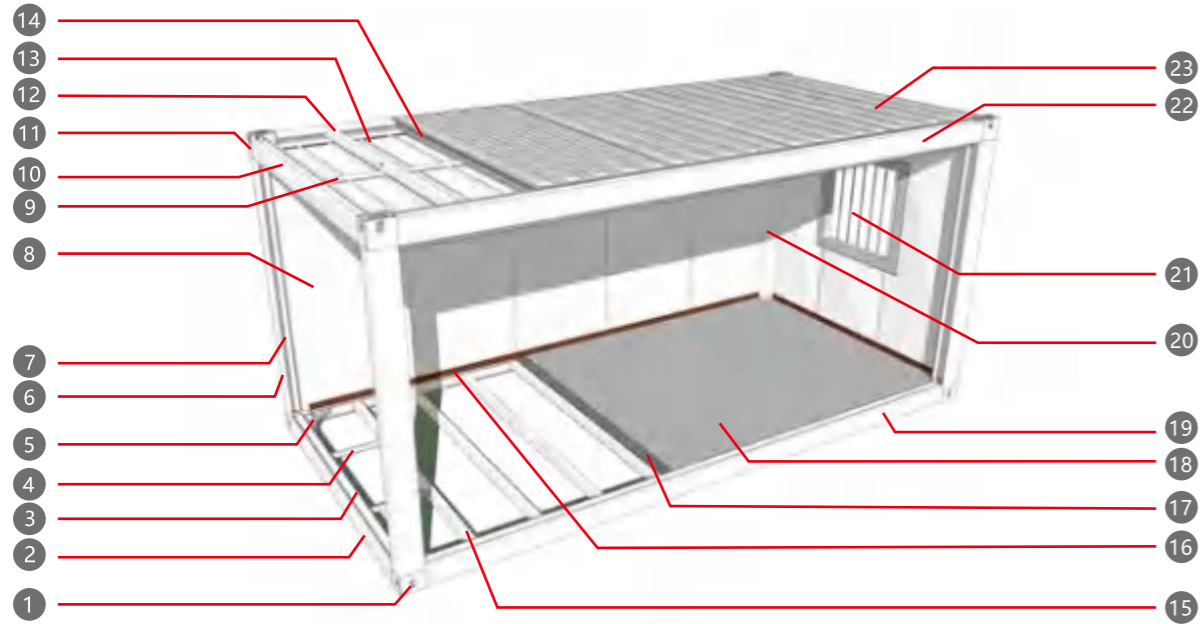

- |                                      |   |
|--------------------------------------|---|
| ① Bottom frame corner fitting        | ⑬ Ceiling panel                                     |
| ② Bottom frame short side beam       | ⑭ 100mm glass insulation cotton                     |
| ③ Flooding trough                    | ⑮ Bottom frame secondary beam                       |
| ④ Bottom frame strengthening beam    | ⑯ PVC skirting line                                 |
| ⑤ Bottom frame bevel reinforced beam | ⑰ Cement fiberboard                                 |
| ⑥ Corner column                      | ⑱ PVC floor leather                                 |
| ⑦ UPVC downpipe                      | ⑲ Bottom frame long side beam                       |
| ⑧ 75mm rock wool sandwich board      | ⑳ Corner column hemming                             |
| ⑨ Ceiling panel connector            | ㉑ Integrated plastic steel window with burglar mesh |
| ⑩ Top frame short side beam          | ㉒ Top frame long side beam                          |
| ⑪ Top frame corner fitting           | ㉓ 1.4mm roof slab                                   |
| ⑫ Top frame secondary beam           |   |

## Types of electrical optional



Plugs



Exhaust fan



Distribution Box



Ceiling lights

## Doors and Windows



PVC door



PVC sliding window

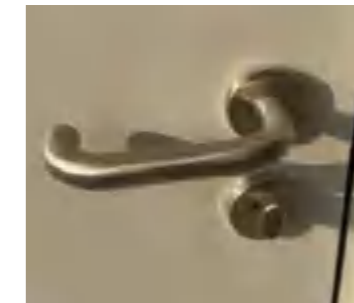

Door handle

## Frame structure of materials



Top frame corner fitting



Corner column hemming



Cement fiberboard



UPVC downpipe

Packing and shipping

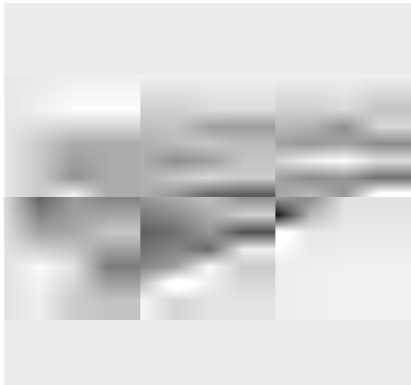
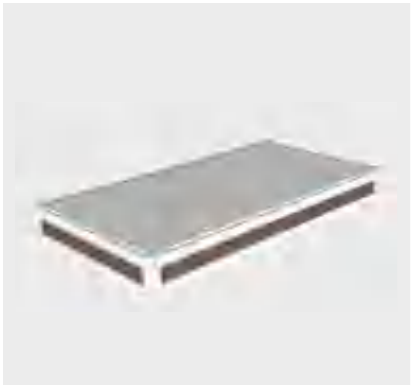

Typical layouts

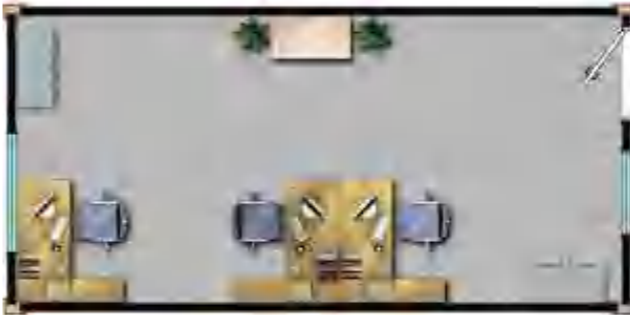

Office



Meeting room

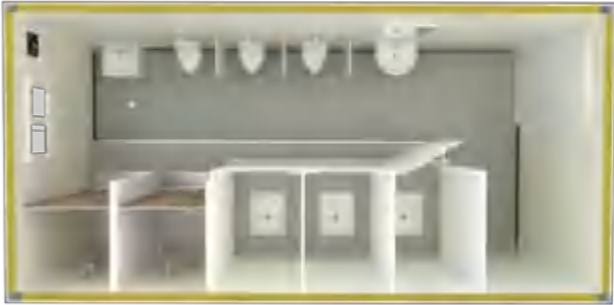

Toilet

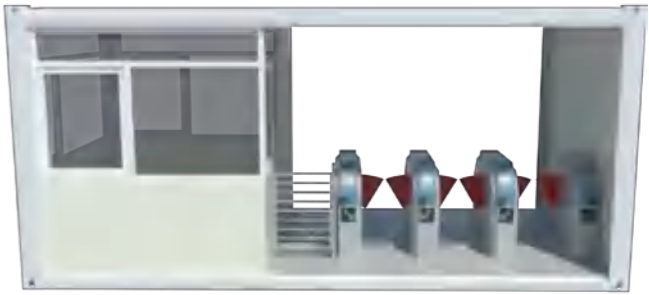

Entrance



Kitchen



Dormitory

# DETACHABLE CONTAINER



# Specification

Product specification	Length*width*height	Inner 5800mm*2800mm*2500mm/Outer 5950mm*3000mm*2800mm
	Roof form	Roof tile, color steel plate
	Drainage form	External drainage organization
	Number of layers	≤3 layers
Design Parameters	Service life	8 years
	Earthquake resistance	Level 8
	Wind resistance	Level 12
	Fire prevention	Class B1, flame retardant



Project CASE

# Material list

Roof	Roof panel	980 type galvanized color coated top tile (0.45mm thick)
	Insulation cotton	5CM thick rock wool, bulk density 14KG
	Ceiling board	Type 981 galvanized color-coated pressure top tile (0.25mm thick)
Floor	Decorative panel	Not included in the standard box, can be customized according to customer requirements, additional charges
	Substrate	Cement sanding board, 1147*2800,
Wall	Wall panel	950 type 50mm rock wool sandwich panel
	Wall panel	*Double-sided color steel plate 0.3mm thick
	Keep warm	*Rock wool, bulk density 80KG
Gate	specification	950*2070
	Material	930*1100
window	specification	925*1200
	Frame material	Aluminum alloy anti-theft window
	glass	Single glass
Electricity	Voltage	
	wire	
	Distribution box	Not included in the standard box, can be customized according to customer requirements, additional charges
	illumination	
decoration	Top and column edging	Color steel angle aluminum
	Skirting	Brown PVC





## Construction Area of K-style Prefab House

W L	Single Floor (3P)			Double Floor (6P)			Triple		
	3K	4K	5K	5K	4K	5K	3K	4K	5K
4K	45.53	59.07	72.61	103.79	130.87	167.95	176.84	217.40	258.08
5K	56.67	73.52	90.38	126.97	160.68	194.39	212.07	262.63	313.19
6K	67.81	87.90	108.14	150.16	180.49	230.82	247.31	307.81	368.30
7K	78.95	102.43	125.90	173.35	220.30	267.28	282.54	352.98	423.41
8K	90.09	116.88	143.67	196.53	250.11	303.69	317.78	398.15	478.52
9K	101.22	131.33	161.43	219.72	279.93	340.13	353.01	443.32	533.63
10K	112.36	145.78	179.19	242.91	309.74	376.57	388.25	488.50	588.74
11K	123.50	160.23	196.96	266.09	339.55	413.00	423.48	533.67	643.85
12K	134.64	174.68	214.72	289.28	369.36	449.44	458.72	578.84	698.96
13K	145.78	189.13	232.48	312.47	399.17	485.88	493.96	624.01	754.07
14K	156.92	203.58	250.25	335.65	428.98	522.31	529.19	669.18	809.18
15K	168.06	218.03	268.01	358.84	458.79	558.75	564.43	714.36	864.29

## PREFABRICATED K HOUSE



Taking the advantages of the strength of sandwich wall panels and rood panels,flat-roof predab houses become a fixed mobile housing system with connectionsof nails





## PREFABRICATED T HOUSE



Prefab T house is a kind of commercial house with complete new ideas. It is composed of light gauge steel keel, sandwich panel integrated by standard module series, and all parts are connected with reinforced screws. It can be assembled and disassembled rapidly and conveniently. Life span can be up to 12-15 years, which can be reused at least 8 times.

# Project

## Specification

- 1、 Life span : 12-20 years.
- 2、 Ind resistance : 88.2-117km/h.
- 3、 Earthquake resistance : 7 grade.
- 4、 Structure : steel structure.



# FOLDABLE CONTAINER

Folding container is the typical modular house which can be installed with only 4 steps. It is environmental protection and widely used in many areas.

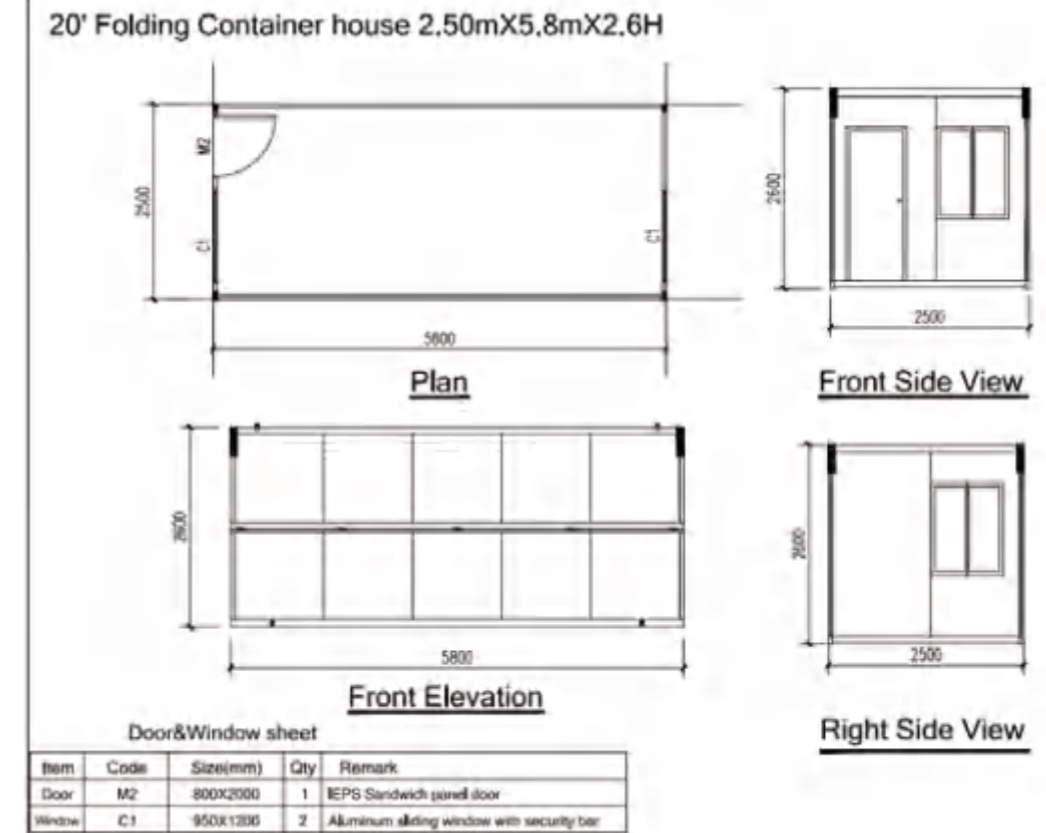

## Introduction

The folding container has the standard modular design and manufacture, and it's environment protective.



# Expandable Container House

## Installation process

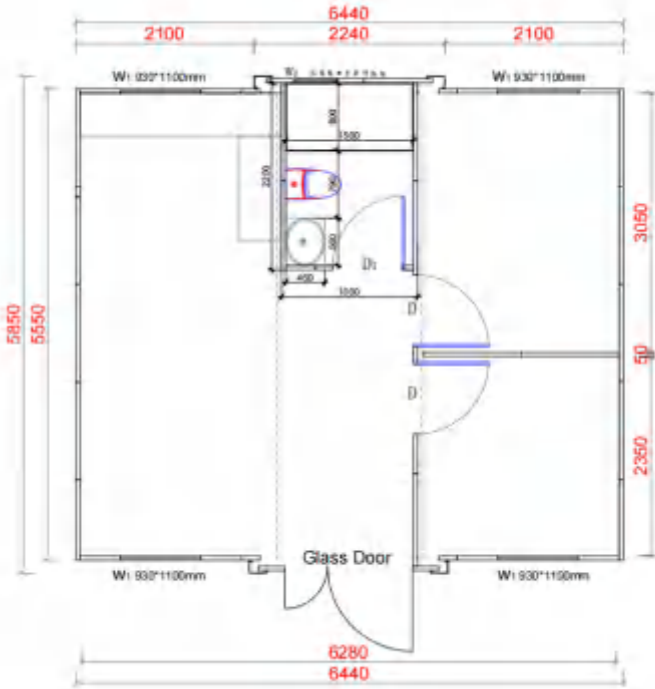

## Product Details

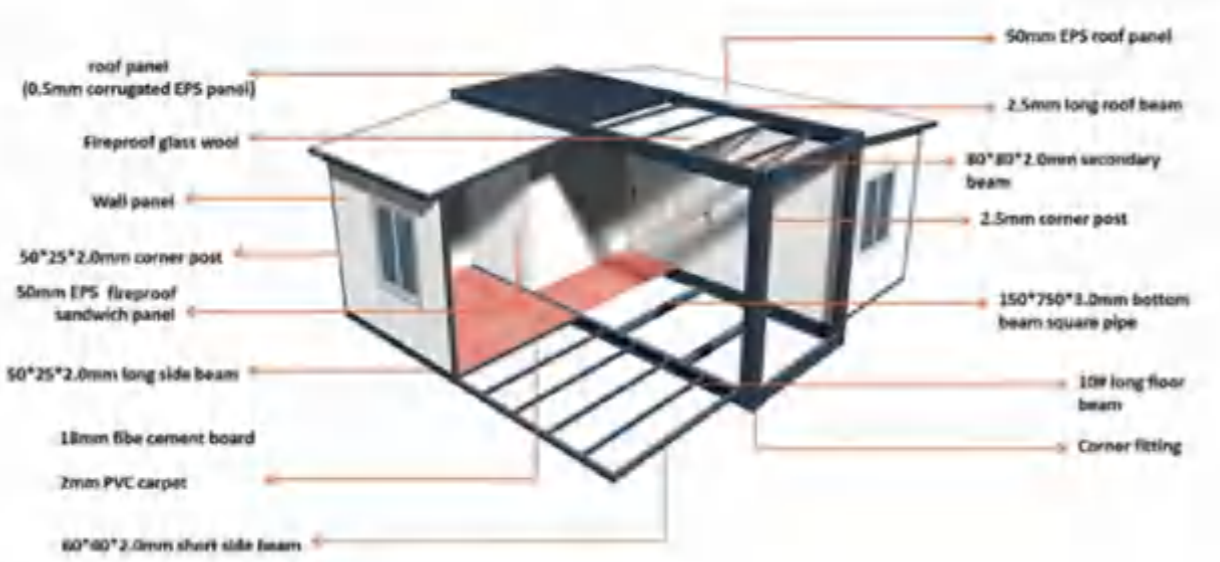

# HDPE PORTABLE TOILET



## Specification

Size:  
1.15m\*1.15m\*2.3m

Accessories:  
Seated toilet bowl;  
waste tank(390L); water holding tank(130L);  
washing basin; water tap;  
Ventilation pipe; foot pumps;  
Mirror; in-use indicator; gender sign; Skid feet;  
Optional soap dispenser & paper roll.

Weight:  
115KGs.

Transportation:  
20GP: 22 units; / 40HQ: 55 units.

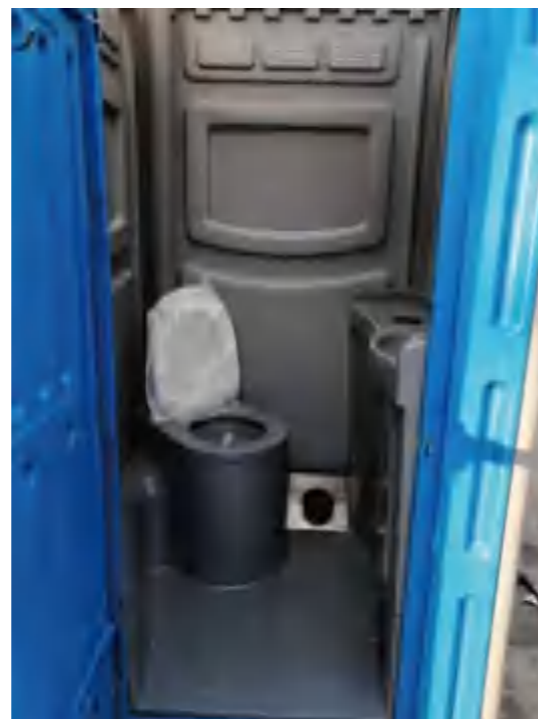

# COLOR STEEL PORTABLE TOILET



Material: EPS color steel composite board  
Specifications: 1100\*1100\*2300  
Inner space size: 970\*970\*1800  
Weight: 100 kg  
Transportation volume:  
3.2m<sup>3</sup> in whole, 1.5m<sup>3</sup> in parts



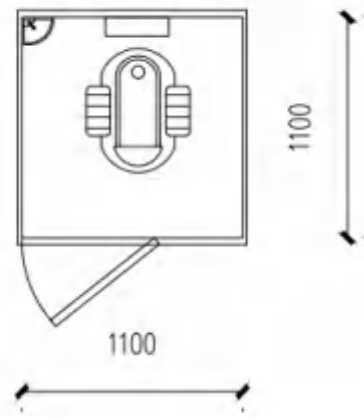
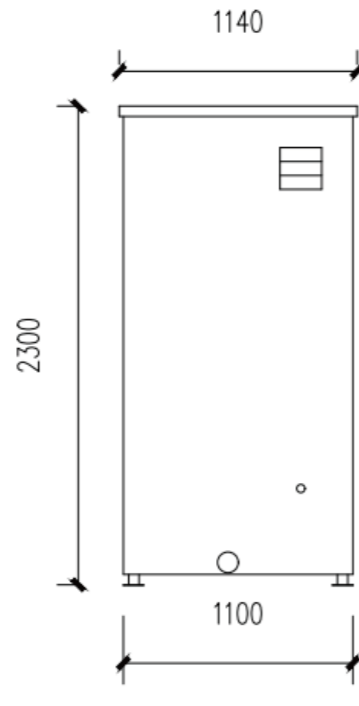
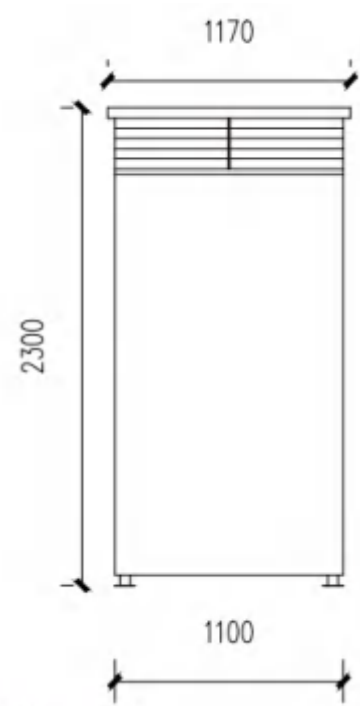

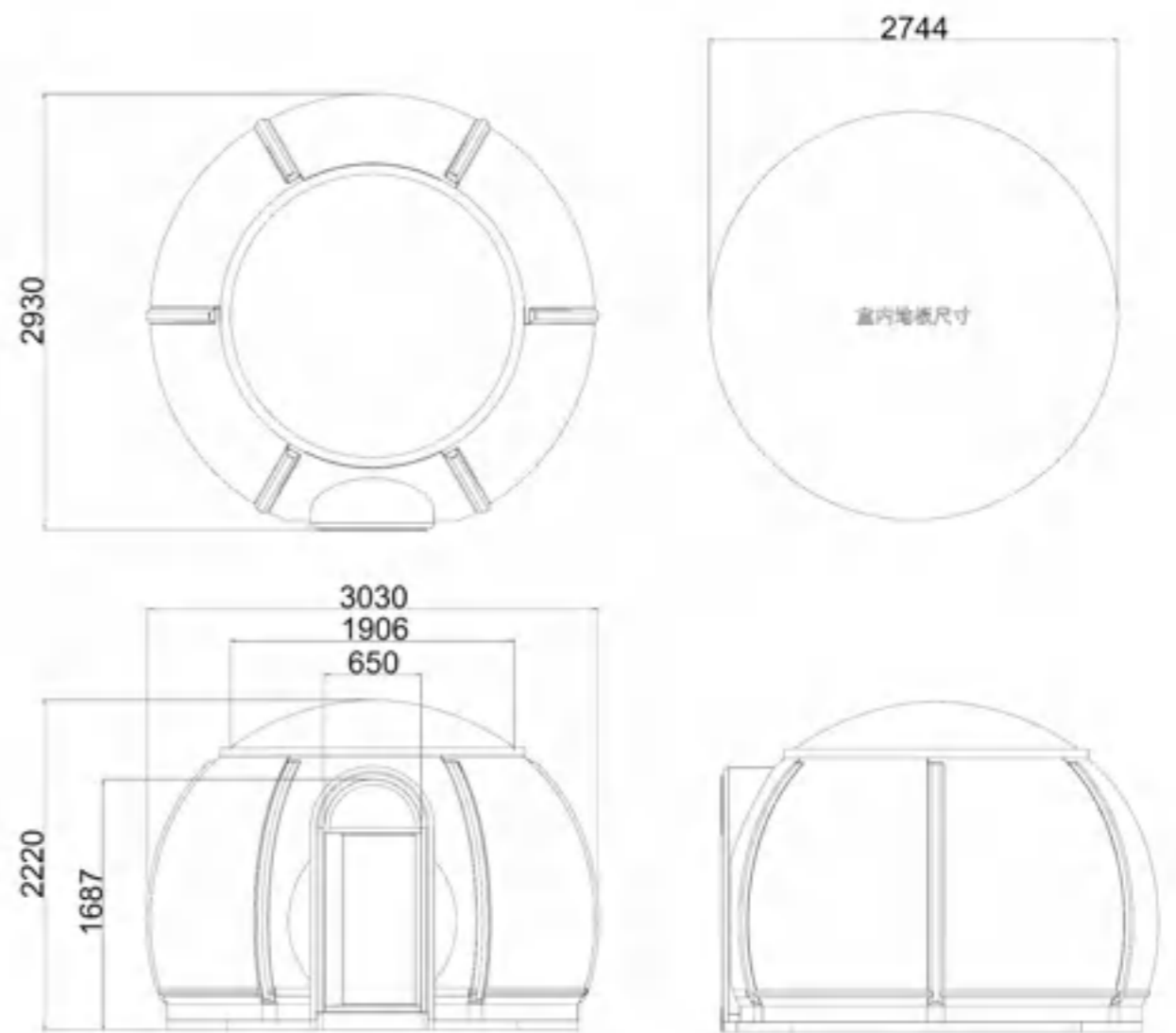

# BUBBLE HOUSE

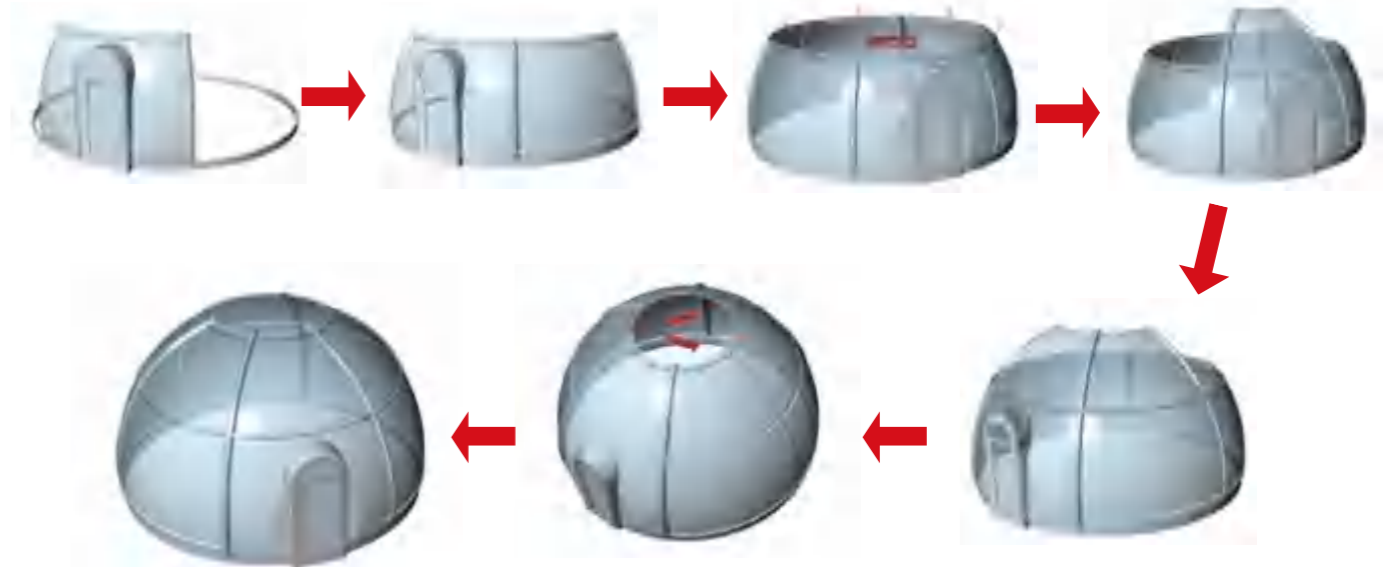



# SLIENT BOX



The modern office environment is adapting to the needs of workers. More and more workers have expressed their desire to find acoustic solutions that can allow them to work in peace and more effectively.



# DIY SHIPPING CONTAINER



It has the most similar lookings with standard shipping container, additional advantages are much more economical, bigger size and insulated itself, Even simple modifications can make it to be amazing dormitory, shop, restaurant, office, bathroom ect. All materials will be prefabricated and prepared in factory, easy welding steps can finish to make your beautiful DIY container house





Meeting room

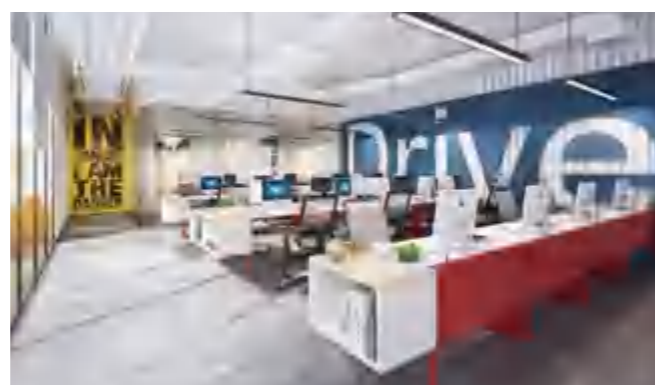

Office



Homestay restaurant



Restroom



Bedroom

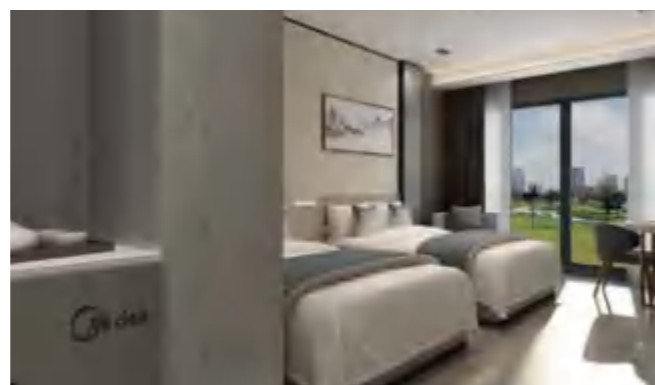

Guestroom



Shipping flat pack container is one of the main products of CGC. Shipping flat-pack container hotel is star level hotel which constructed by the traditional shipping flat-pack box as component, through flexibly combining the internal space, designing space by modular way , adding doors and windows, improving sound insulation meanwhile, decorating the interior with star residential space standards , plus soft collocation, household appliances, furniture and household accessories to create a star standards living space. The long and square type of shipping flat-pack container can also be a hotel room for vacation after well-designed . The shipping flat-pack box hotel not only shortens the construction period and saves the cost, but also can be recycled and reused in the future, which is more in line with the concept of green environmental protection.

CGC Office Building Plan



Indonesia Samanea Commercial City



Gaodeng International Plaza Marketing Center Project, Gaoming District, Foshan City

---



Manager Department, EPC Project of New City Interchange, by China Railway Bridge Bureau Group Sixth Engineering Co., Ltd.

---



Shenzhen Tea Expo Garden

---



Zhuhai Hengqin Star Music Camp

---









# STEEL STRUCTURE FEATURES

In terms of structural performance:

- 1. Excellent seismic performance
- 2. Light structure
- 3. High construction accuracy
- 4. Carry out a variety of architectural creative modeling

In terms of economic benefits:

- 1. Save the basic cost
- 2. Short construction period and small space occupation
- 3. Low investment risk
- 4. Improve space utilization

In terms of environment protect:

- 1. Less site pollution
- 2. Green
- 3. Energy-saving

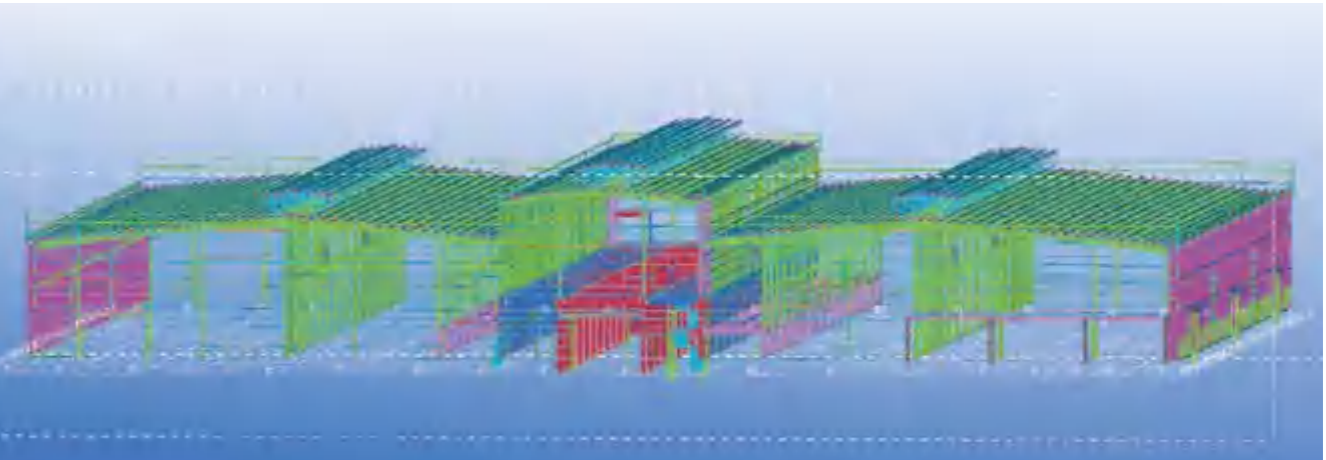

# PROJECT



Project: Fujian Lesso Factory  
Work Scope: 3 Factories  
Site area: 67,000 m<sup>2</sup>  
Lead time: Nov, 2020



Project: Jiangxi Lesso Factory  
Work Scope: 3 factories  
Site area: 250,000 m<sup>2</sup>  
Lead time:  
Nov, 2020 for 3 Factories;  
Feb, 2021 for 12 Factories



Project: Indonesia Lesso Factory  
Work Scope: 3 Factories  
Site area: 37,230 m<sup>2</sup>  
Lead time: Feb, 2021

Cambodia Investment Promotion Center in Phnom Penh



Jiangxi Nanchang Lesso Technology Co., Ltd. project



Phase II Project of Yunnan Lesso Technology Development Co., Ltd.



Fujian Lesso New Material Technology Co., Ltd. Phase I Plant Project

